

**SPECIFICATIONS**

**CONTACT RATING :** Dependent upon contact material See page 29.

**ELECTRICAL LIFE :** 30,000 make-and-break cycles at full load.

**CONTACT RESISTANCE :** 20mΩ max. initial @ 2-4 VDC. 100 mA for both silver and gold plated contacts.

**INSULATION RESISTANCE :** 1,000 MΩ min.

**DIELECTRIC STRENGTH :** 1,000 V RMS min. @ sea level.

**OPERATING TEMPERATURE :** -30°C to 130°C.

**MATERIALS**

**CASE :** Diallyl phthalate (DAP)(UL94V-0).

**ACTUATOR :** Brass, chrome plated.



**BUSHING :** Brass, nickel plated.

**HOUSING :** Stainless steel.

**SWITCH SUPPORT :** Brass,tin plated.

**TERMINAL/CONTACT :** Silver or gold plated. See page 29.

**TERMINAL SEAL :** Epoxy

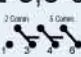
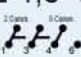
NO. POLES	MODEL NO.	SWITCH FUNCTION			CONNECTED TERMINALS/SCHEMATIC		
		POS.1	POS.2	POS.3	POS.1	POS.2	POS.3
SP	DS-40	ON	NONE	OFF			
	DS-41	ON	NONE	ON	2-3	OPEN	2-1
	DS-42	ON	NONE	MOM		OPEN	
	DS-43	ON	OFF	ON			
DP	DS-51	ON	NONE	ON	2-3,5-6	OPEN	2-1,5-4
	DS-52	ON	NONE	MOM		OPEN	
	DS-53	ON	OFF	ON			

MOM=MOMENTARY

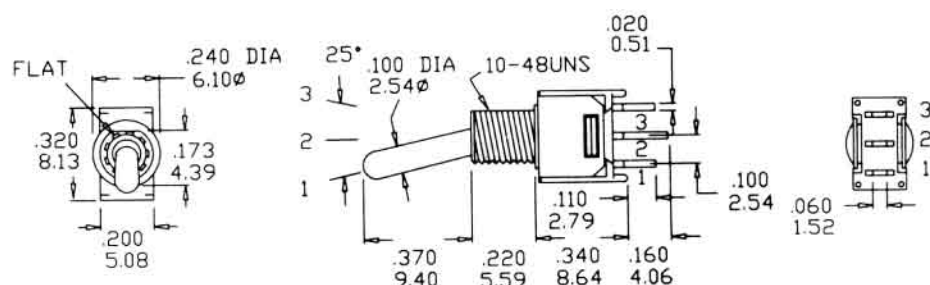

SPDT Part No.DS-41T1B1A1QN

# DS500 Series

## Sub-Miniature Toggle Switches

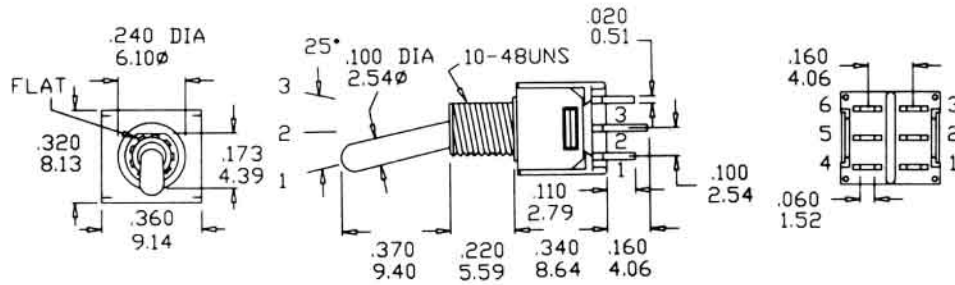

DPDT Part No.DS-51T1B1A1QN

**A3**

P.C. MOUNTING

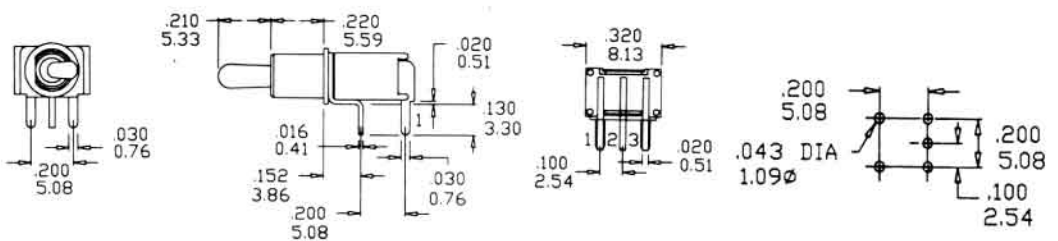

SPDT Part No.DS-41T2B2A3QN

**A3**

P.C. MOUNTING

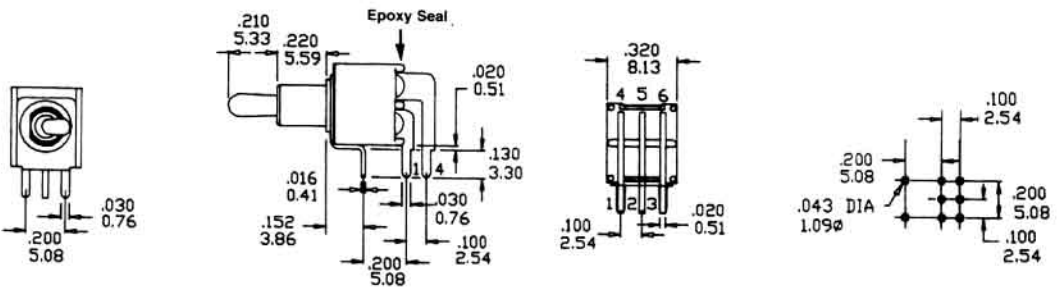

DPDT Part No.DS-51T2B2A3QE

**A4**

P.C. MOUNTING

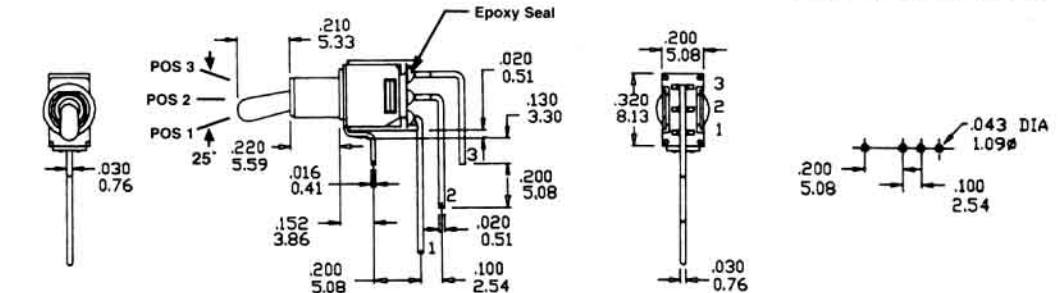

SPDT Part No.DS-41T2B2A4QE

**A4**

P.C. MOUNTING

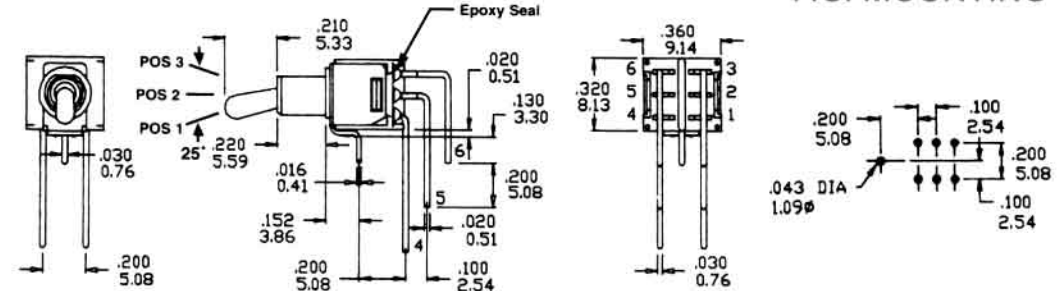

DPDT Part No.DS-51T2B2A4QE

# DS500 Series

# Sub-Miniature Toggle Switches

## VS1

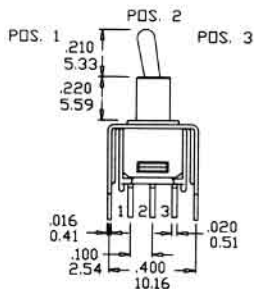

P.C. MOUNTING

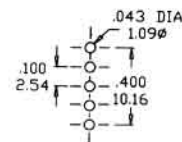
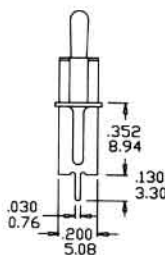

SPDT Part No.DS-41T2B2VS1QN

## VS1

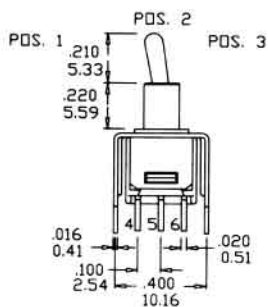

P.C. MOUNTING

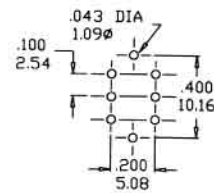
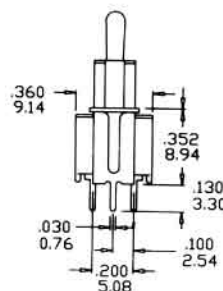

DPDT Part No.DS-51T2B2VS1QN

## ACTUATOR OPTIONS

T1

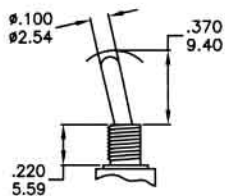

T2

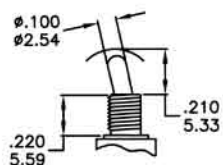

T3

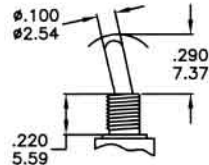

T4

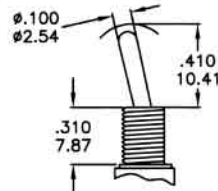

T5

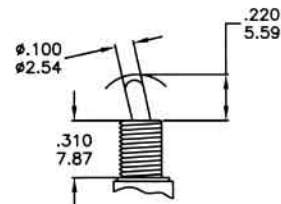

## BUSHING OPTIONS

B1 THD

B2 NON-THD

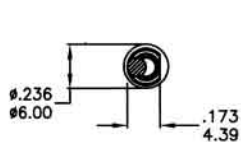

B3 THD

B4 NON-THD

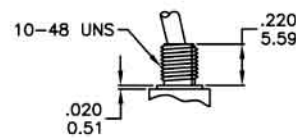
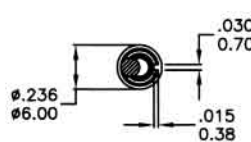
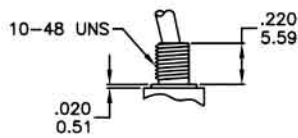

B5 THD

B6 NON-THD

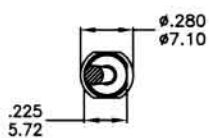

B7 THD

B8 NON-THD

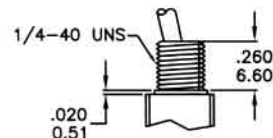
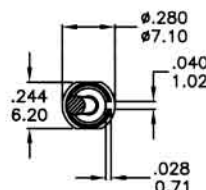
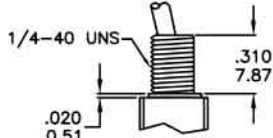

**TERMINATION OPTIONS**

A1

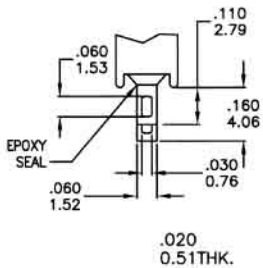

A2

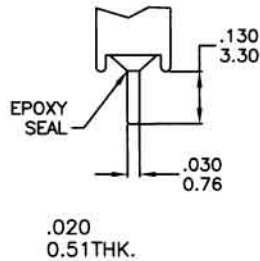

A3

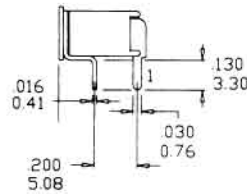

A4

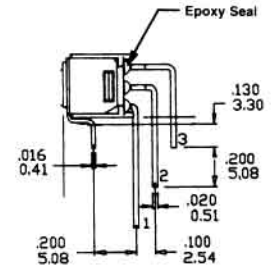

**CONTACT RATING**

**Q**

- FIXED TERMINAL** : Silver plated over copper alloy
- MOVING CONTACT** : Silver plated over copper alloy
- RATING** : 3 Amps with resistive load@120VAC or 28VDC  
1.5 Amps with resistive load@250VAC

**G**

- FIXED TERMINAL** : Copper alloy with gold plated over nickel plate
- MOVING CONTACT** : Copper alloy with gold plated over nickel plate
- RATING** : 0.4 Volt-Amps(VA) max. @20V max. (AC or DC)

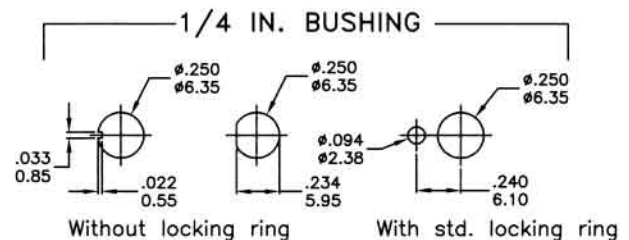
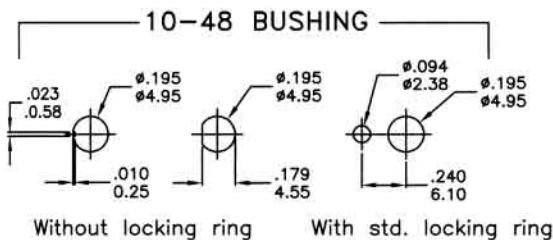

**PANEL MOUNTING**

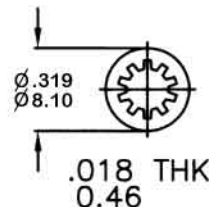
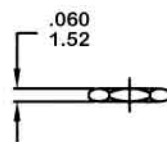
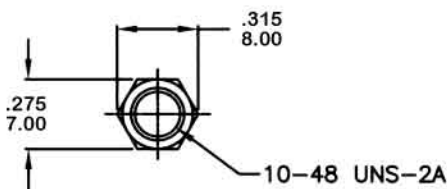

**HARDWARE**

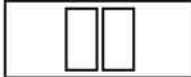

**HOW TO ORDER**

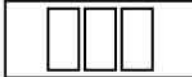
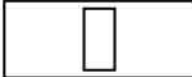
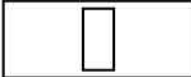
MODEL NO.	ACTUATOR	BUSHING	TERMINATIONS	CONTACT MATERIAL	SEAL
					
DS-40 DS-41 DS-42 DS-43 DS-51 DS-52 DS-53	T1 T2 T3 T4 T5	B1 B2 B3 B4 B5 B6 B7 B8	A1 A2 A3 A4 VS1	Q=Silver G=Gold	E=EPOXY N=NO EPOXY