

# A400 Series

## Snap-Acting Pushbutton Switches

### SPECIFICATIONS

**CONTACT RATING :** Dependent upon contact material See page 21.

**ELECTRICAL LIFE :** 50,000 make-and-break cycles at full load.

**CONTACT RESISTANCE :** 10mΩ max. initial @ 2-4 VDC. 100 mA for both silver and gold plated contacts.

**INSULATION RESISTANCE :** 1,000 MΩ min.

**DIELECTRIC STRENGTH :** 1,000 V RMS min. @ sea level.

**OPERATING TEMPERATURE :** -30°C to 130°C.

### MATERIALS

**CASE :** Diallyl phthalate (DAP)(UL94V-0).

**ACTUATOR :** Glass filled Nylon or Glass filled Polyester.

**BUSHING :** Brass, nickel plated.

**HOUSING :** Stainless steel.

**SWITCH SUPPORT :** Brass,tin plated.

**TERMINAL/CONTACT :** Silver or gold plated. See page 21.

**TERMINAL SEAL :** Epoxy

NO. POLES	MODEL NO.	SWITCH FUNCTION		CONNECTED TERMINALS		SCHEMATIC
		POS.1	POS.2	POS.1	POS.2	
SP	A101	ON	MOM	1-3	1-2	
DP	A202	ON	MOM	1-3,4-6	1-2,4-5	

MOM=MOMENTARY



SPDT Part No.A101B1A1QE

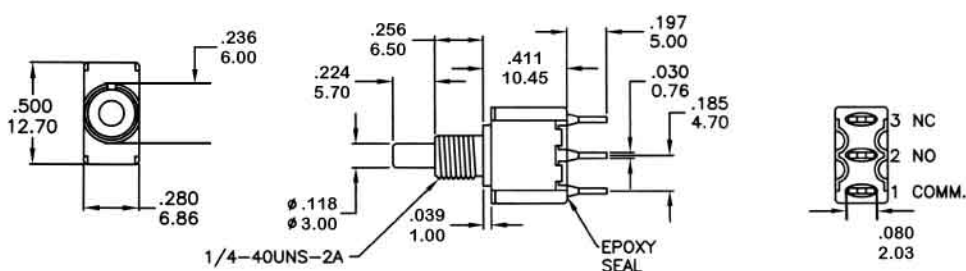

DPDT Part No.A202B1A1QE

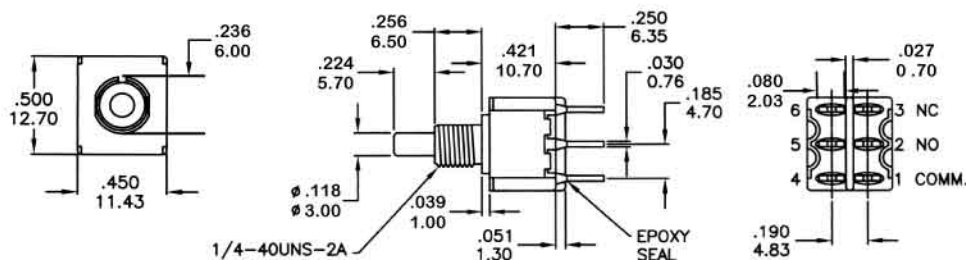

# A400 Series

# Snap-Acting Pushbutton Switches

## A3

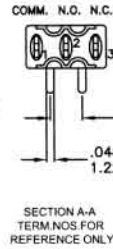
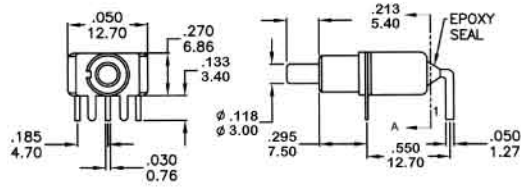

P.C. MOUNTING

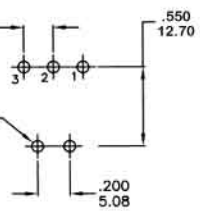

SPDT Part No.A101B2A3QE

## A3

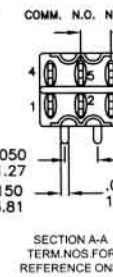
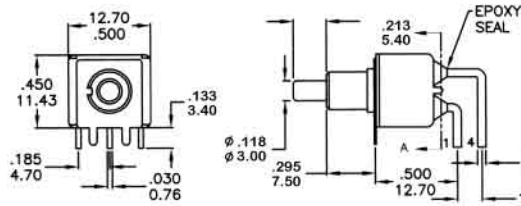

P.C. MOUNTING

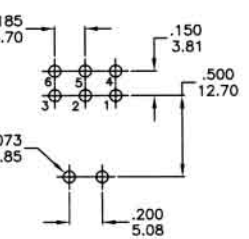

DPDT Part No.A202B2A3QE

## A4

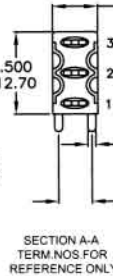
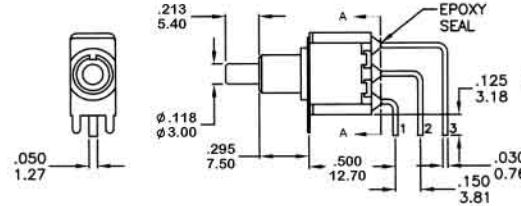

P.C. MOUNTING

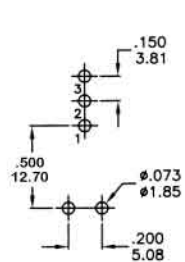

SPDT Part No.A101B2A4QE

## A4

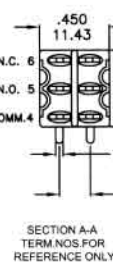
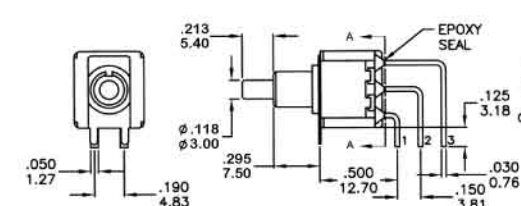

P.C. MOUNTING

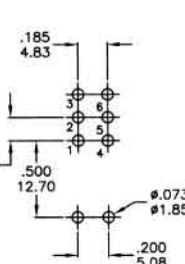

DPDT Part No.A202B2A4QE

## A7 CAP & FRAME

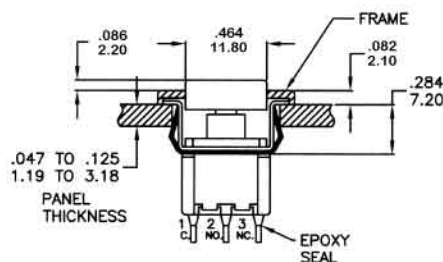
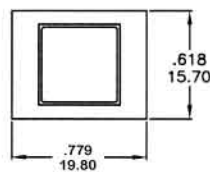

PANEL LAYOUT

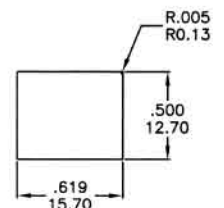

SPDT Part No.A101A7A1QE

# A400 Series

# Snap-Acting Pushbutton Switches

## BUSHING OPTIONS

B1 THD STD  
B2 NON-THD

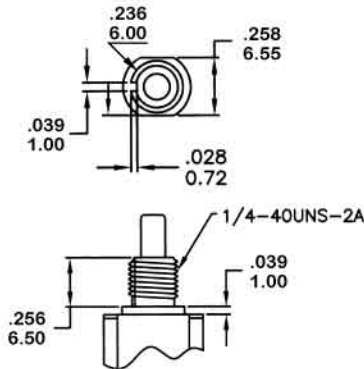

B3 THD STD  
B4 NON-THD

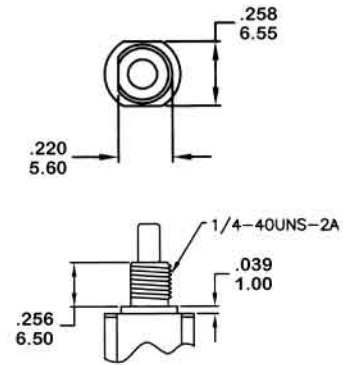

## TERMINATION OPTIONS

A1

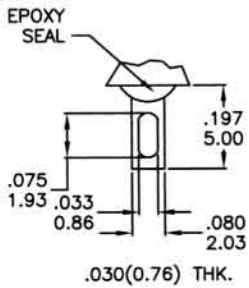

A2

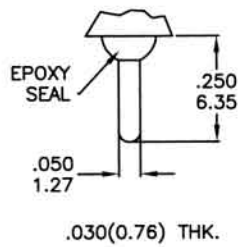

A3

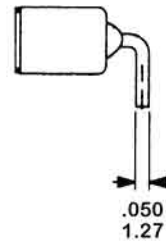

A4

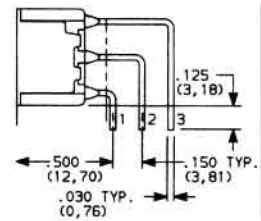

## CONTACT RATING

**Q**

**FIXED TERMINAL** : Silver plated over copper alloy

**MOVING CONTACT** : Silver plated over copper alloy

**RATING** : 5 Amps with resistive load@120VAC or 28VDC

2 Amps with resistive load@250VAC

**G**

**FIXED TERMINAL** : Copper alloy with gold plated over nickel plate

**MOVING CONTACT** : Copper alloy with gold plated over nickel plate

**RATING** : 0.4 Volt-Amps(VA) max. @20V max. (AC or DC)

## CAPS

C1

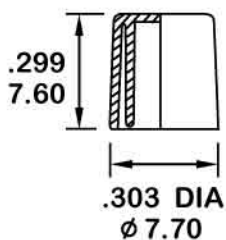

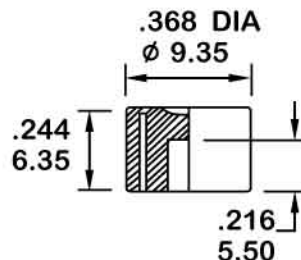

C2

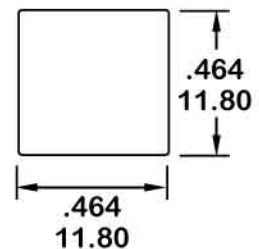

A7 CAP

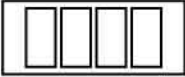
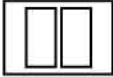
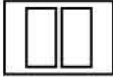

**HOW TO ORDER**

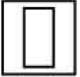
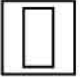
MODEL NO.	BUSHING	TERMINATIONS	CONTACT MATERIAL	SEAL	CAP/COLOR	FRAME/COLOR FOR A7 OPTIONS
						
A101 A202	B1 B2 B3 B4 A7	A1 A2 A3 A4	Q=Silver G=Gold	E=EPOXY N=NO EPOXY	1 (Black std.) 2 (Red) 3 (Green) 4 (Blue) 5 (Gray) 6 (White) 7 (Yellow)	1 (Black std.) 2 (Red) 3 (Green) 4 (Blue) 5 (Gray) 6 (White) 7 (Yellow)